

# 75

## SUMMER STREET

FINANCIAL DISTRICT  
BOSTON, MA

1,442 SF STREET LEVEL  
730 SF LOWER LEVEL

# RETAIL SPACE FOR LEASE





# 75

## SUMMER STREET

FINANCIAL DISTRICT  
BOSTON, MA

1,442 SF STREET LEVEL  
730 SF LOWER LEVEL

### IN THE NEIGHBORHOOD



Venture Retail Partners is pleased to offer for lease this highly visible retail opportunity in the heart of the Financial District. Located on the heavily traveled corridor of Summer Street, the property is surrounded by a variety of retailers, office buildings and employees. The site is easily accessible to South Station, Downtown Crossing and Park Street among other public transportation spots. Retailers in the immediate trade area include Bank of America, Wendy's, Tatte Bakery, Starbucks, Chipotle, Dunkin Donuts, Webster Bank, Macy's, Five Guys, Chase Bank, Citizen's Bank, 7-Eleven, Sweetgreen, Café Nero, CVS and many others.

### BY THE NUMBERS

#### FINANCIAL DISTRICT STATISTICS

- Over 320,000 employees in the immediate area
- Less than 0.25 miles to South Station, Park Street and Downtown Crossing T Stops
- Over 76,000 residents
- Located in the heart of the city's Financial District, over 18,000 companies

### DEMOGRAPHICS



#### POPULATION

0.25 Mile: 8,261  
0.50 Mile: 20,649  
0.75 Mile: 46,819  
1 Mile: 76,498



#### AVERAGE HOUSEHOLD INCOME

0.25 Mile: \$149,838  
0.50 Mile: \$158,071  
0.75 Mile: \$162,190  
1 Mile: \$174,204



#### DAYTIME EMPLOYEES

0.25 Mile: 64,647  
0.50 Mile: 168,024  
0.75 Mile: 236,903  
1 Mile: 320,835



# 75 SUMMER STREET | FINANCIAL DISTRICT - BOSTON, MA





## STREET LEVEL FLOOR PLAN - 1,442 SF

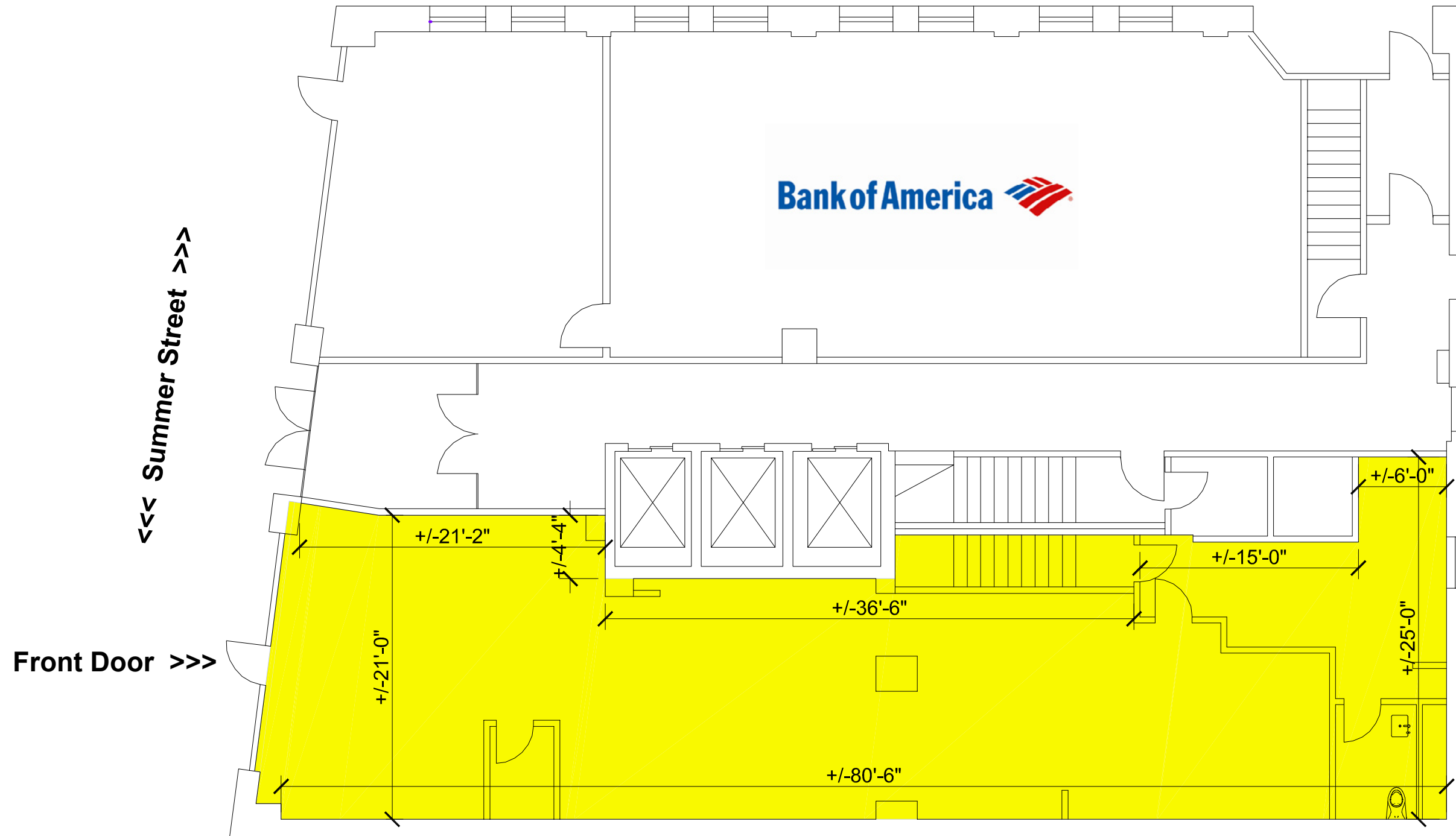

## LOWER LEVEL FLOOR PLAN - 730 SF

